

EXPANSION JOINTS FOR THE CONSTRUCTION INDUSTRY

POLYJOINT is manufactured from the Original High Quality, Cross Linked, Closed Cell Polyethylene Foam, used as an Expansion Joint Filler in both Brickwork and Concrete

- Clean and light to handle and does not deteriorate in storage or on site.
- Cut strips are supplied with a tear-off strip to form a sealant rebate.
- No necessity to pre-cut holes for dowel bars.
- Non Water Absorbent.
- High Level of Chemical and Ozone Resistance.
- Excellent Physical Compression Recovery Properties
- Standard Polyjoint for use in brickwork/blockwork and concrete expansion joints.
- Super Polyjoint for use in water retaining and excluding structures (**WCA Approved**), bridge and road expansion joints.

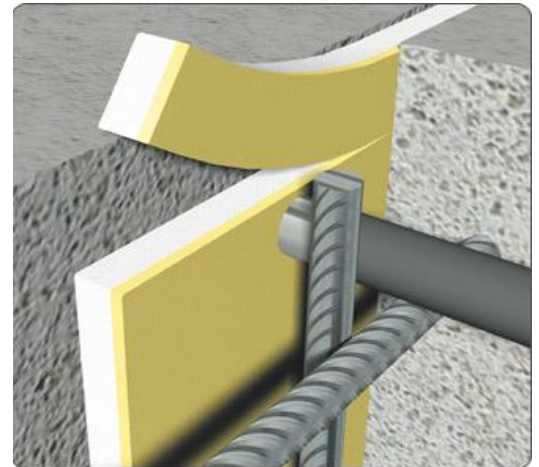

Standard Sizes	Sheets:	2m x 1m		
	Cut Strip:	Depth:	100mm/150mm/175mm/200mm	
		Thickness:	10mm/12mm/15mm/20mm/25mm	

OTHER SIZES MADE TO ORDER

Thicknesses up to 15mm supplied in 10m rolls, 20mm & 25mm in 2m lengths, all Super Polyjoint cut strip supplied in 2m lengths.

Technical Data

Property	Polyjoint	Super Polyjoint
Density	35kg/m ³	65kg/m ³
Tensile Strength MD	ISO 1798 0 kpa	ISO 1798 696 kpa
Tensile Strength TD	ISO 1798 310 kpa	ISO 1798 586 kpa
Elongation MD	ISO 1798 0	ISO 1798 109%
Elongation TD	ISO 1798 125%	ISO 1798 124%
Compression		
10%	ISO 844 29 kpa	ISO 844 39 kpa
25%	ISO 844 48 kpa	ISO 844 73 kpa
50%	ISO 844 110 kpa	ISO 844 149 kpa
Recovery after 50% compression		
5hrs	ISO 1856 42%	ISO 1856 35.5%
24hrs	ISO 1856 26%	ISO 1856 15%
Weathering	No Disintegration	No Disintegration
Chemical Resistance Acids/Oils/Alkalis	Resistant to all (except concentrated nitric)	Resistant to all (except concentrated nitric)
Water Absorbtion	Negligible	Negligible