

## Bitusheet Asphaltic Compound

### Description

Bitusheet Asphaltic compound is a damp proof solution, used in two coats to provide a damp proof membrane in solid floors, or for protecting foundations, retaining walls, abutments, beams, lintols and similar structures against moisture.

### Application

Construction techniques should conform to relevant codes of practice, with particular attention to BS8102: All surfaces to which the Asphaltic Compound is to be applied should be smooth, clean, dry and free from grease or other contaminants. Any sharp points should be removed prior to application and internal or external corners should be eased with a sand cement fillet.

Apply first coat of Liquid Asphaltic Compound at 1.5m<sup>2</sup>/L, brushing well to ensure complete coverage. Allow to dry thoroughly before applying the second coat at 2.5m<sup>2</sup>/L. Ensure that the membrane is fully dry before proceeding.

**N.B** Drying times may be extended in cold, humid conditions, or in areas of poor ventilation. Once applied the membrane should be protected with a suitable protection board.

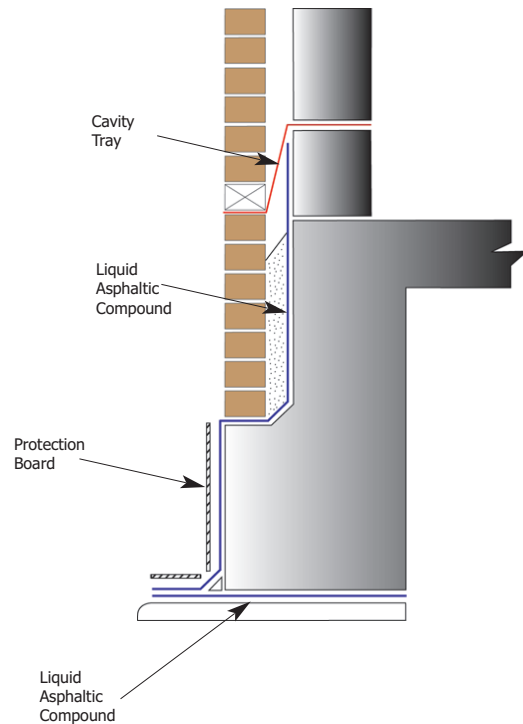

Please contact our Technical department should you require further information or project specific application details

NSPlus

Typical Properties	Value	Test Method
Specific Gravity	0.92 (approx)	
Flash Point	32°C	
Water Vapour Permeability	0.08g/m <sup>2</sup> per 24hr	
Packaging	25 or 200 litre containers	

SCP CONCRETE SEALING TECHNOLOGY LTD

Crowbush Farm Business Park, Luton Road, Toddington, Beds LU5 6HU United Kingdom

Telephone: +44(0)1525 872700.

Facsimile: +44(0) 1525 871019

Email: info@scpwaterproofing.com

Web: scpwaterproofing.com