

BITUTHENE® Mastic

Trowel applied bituminous mastic for use with GCP waterproofing membranes

Product Description

BITUTHENE® Mastic is a cold applied one part solvent based bituminous mastic used to seal BITUTHENE® membranes when terminated in concrete chases or in raked mortar joints in masonry. It can also be used in membrane termination chases which are below ground or not exposed to the elements.

BITUTHENE® Mastic has been designed to complement the range of BITUTHENE® waterproofing systems and assists with the application by solving small detailing problems.

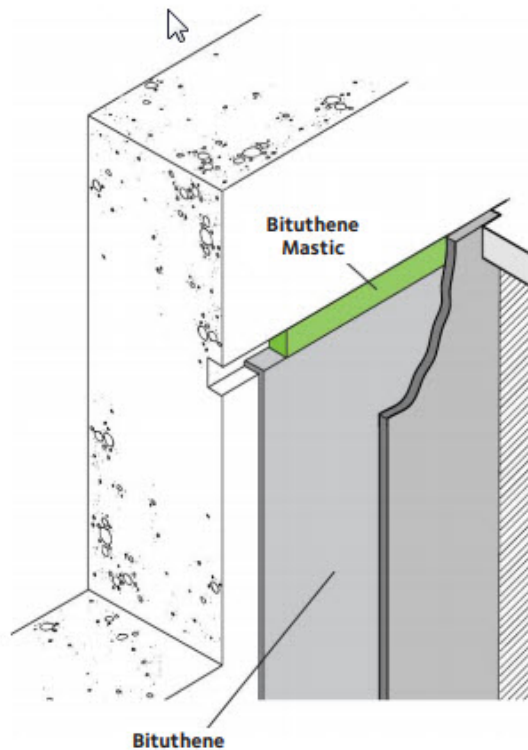

bituthene-mastic

Details shown are typical illustrations only and not working drawings. For assistance with working drawings and additional technical advice please contact GCP Technical Services.

Product Advantages

- No mixing necessary
- Simple application – trowel applied directly to substrate or membrane

Installation

Do not use below +4 °C. Surfaces shall be dry, flat, free of sharp protusions and hollows. Use a stiff brush and airline to remove dust and all contaminants. Use a trowel or spatula to scoop mastic from can and apply firmly into joints and corners, compacting mastic well to avoid air entrainment. BITUTHENE® Mastic remains soft for several months.

Limitations

For detailing under head pressure use BITUTHENE ® LM.

Health and Safety

Read the product carton and Safety Data Sheet (SDS) before use. Users must comply with all risk and safety phrases. SDS’s can be obtained from GCP Applied Technologies.

SUPPLY/KEY DATA	
BITUTHENE® Mastic	4.5 litre can
Weight	6.5 kg/unit
Storage	Keep in sealed containers below +25 °C away from sources of ignition
Equipment by others	Trowel or Spatula

gcpat.uk | United Kingdom customer service: +44 (0) 1480 478421

We hope the information here will be helpful. It is based on data and knowledge considered to be true and accurate, and is offered for consideration, investigation and verification by the user, but we do not warrant the results to be obtained. Please read all statements, recommendations, and suggestions in conjunction with our conditions of sale, which apply to all goods supplied by us. No statement, recommendation, or suggestion is intended for any use that would infringe any patent, copyright, or other third party right.

BITUTHENE is a trademark, which may be registered in the United States and/or other countries, of GCP Applied Technologies Inc. This trademark list has been compiled using available published information as of the publication date and may not accurately reflect current trademark ownership or status.

© Copyright 2018 GCP Applied Technologies Inc. All rights reserved.

GCP Applied Technologies Inc., 62 Whittemore Avenue, Cambridge, MA 02140 USA

In the UK, Ipswich Road, Slough, Berkshire, SL1 4EQ, UK
This document is only current as of the last updated date stated below and is valid only for use in the United Kingdom. It is important that you always refer to the currently available information at the URL below to provide the most current product information at the time of use. Additional literature such as Contractor Manuals, Technical Bulletins, Detail Drawings and detailing recommendations and other relevant documents are also available on www.gcpat.uk. Information found on other websites must not be relied upon, as they may not be up-to-date or applicable to the conditions in your location and we do not accept any responsibility for their content. If there are any conflicts or if you need more information, please contact GCP Customer Service.