



# SOLUTIONS FOR ROOFS AND WALKWAYS

Sikalastic® RoofPro



# POLYURETHANE WATERPROOFING SYSTEMS FOR FLAT ROOFS

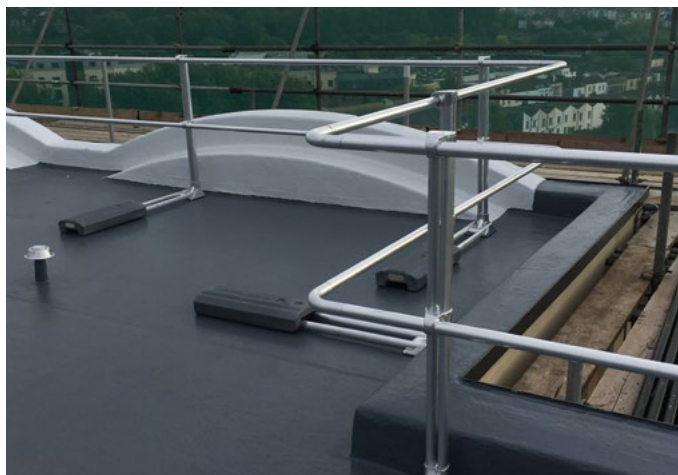

Sika has been manufacturing high performance protection and waterproofing systems for over 50 years. The Sikalastic® RoofPro coating is a single component, cold applied, moisture-triggered, liquid waterproofing membrane, that cures to form a seamless, durable and weather resistant waterproofing solution for exposed roof areas. The range has all the inherent advantages of using liquid membranes, as well as offering the benefit of being a cost effective alternative to other options available in the market.

Sikalastic® RoofPro incorporates technology that allows the material to use atmospheric moisture to trigger the curing process. This means that the waterproofing membrane is capable of curing in a wide range of conditions, making it ideal for use in the unpredictable UK climate. Unlike traditional polyurethane systems, it does not release CO<sub>2</sub>, which can cause gassing, and application is not delayed by adverse weather, which means roofing works are not slowed down.

## SYSTEM FEATURES:

- **Cold Applied** – cold applied application
- **Seamless** – eliminating the possibility of joint failure through poor workmanship
- **Quick and Easy Application** – using glass fibre matting to allow simple application in detail areas
- **Cost Effective** – especially on complex roofs
- **High Elasticity** – allowing for greater thermal movement
- **Guarantees** – BBA in excess of 25 years and guaranteed upto 20 years
- **BBA Accreditation** (BBA certificate 18/5540) and **ETA Accreditation** (ETA No 13/0456) (and is therefore CE marked)



# Sikalastic® D-20 RoofPro One SPECIALIST ONE DAY SOLUTION



Our pioneering research and development has ensured continual advancements in technology and production of the Sikalastic® STP range, a liquid applied waterproofing membrane for use on flat roofs that has been developed using a new innovative Silane Terminated Polymer (STP) technology. This technology was developed in the sealant market and combines the durability characteristics similar to that of a polyurethane, with the weather resistance of silicones.

Sikalastic® D-20 RoofPro One has been developed as a specialist coating to complement our range. The Sikalastic® D-20 RoofPro One emits virtually no odour when compared to many other liquid systems, which makes it ideal for use on the roofs of occupied buildings such as hospitals, food manufacturing plants, schools, domestic dwellings such as extensions, garages and smaller flat roofs.

The single pack, solvent free, cold applied liquid membrane is reinforced using a polyester fleece and is installed wet-on-wet. This means that the polyester reinforcement fleece is first saturated with Sikalastic® D-20 RoofPro One, bonding the membrane to the substrate, with the surface layer then applied onto the bonding coat whilst still wet, forming a single seamless membrane of uniform thickness. The saturation of the fleece determines the correct application rates, making material consumption easy to monitor and verify. The advantage of this type of application is that on smaller roofs a one day application may be possible, because there is no need to wait for curing between coats.

## Sikalastic® D-20 RoofPro One PRODUCT RANGE

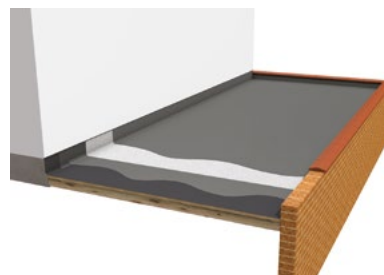

System build up:

- Sikalastic® D-20 RoofPro One
- Sikalastic® Fleece 120
- Sika® Cleaner P
- Substrate\*

\*Prime as required

## SYSTEM FEATURES:

- Low Odour – minimises the chance for disruption to the operation of the building due to nuisance odours
- Low VOC (Volatile Organic Compounds) reduces impact on the environment
- Wet-on-Wet Application – membrane and reinforcement applied in one operation, minimising time and reducing labour costs
- Cold Applied – cold applied application
- Seamless – eliminates the possibility of joint failure through poor workmanship

# Sikalastic® RoofPro PU SYSTEMS



## EASY APPLICATION USING GLASS FIBRE MATTING

**The membrane is applied in two coats: an embedment coat, which is reinforced with Sika Reemat Premium (chopped strand glass fibre mat), and once this is cured, a top coat is added to complete the system.**

The small amounts of solvent present within the polyurethane product 'breaks down' the emulsion binder in the matting, enabling it to become easily moulded around detail areas, allowing quick application, particularly on complex roofs.

The glass fibre mat provides the membrane with exceptional tensile strength, to withstand thermal movement in the substrate.



## Sikalastic® RoofPro WATERPROOF COATING

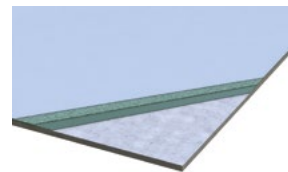

Cures to form a seamless, durable and weather-resistant waterproofing solution for exposed roof areas.

System build-up:

- Sikalastic® RoofPro/ Advanced Top Coat
- Sika® Reemat Premium Embedded
- Sikalastic® RoofPro/ Advanced Embedment Coat
- Substrate\*

\*prime as required

## Sikalastic® RoofPro WATERPROOF COATING FOR WARM ROOFS

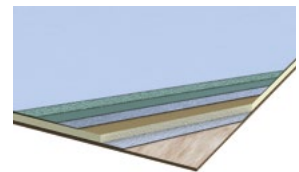

Cures to form a seamless, durable and weather-resistant waterproofing solution for warm roof areas.

System build-up:

- S-Vap 5000 E SA
- Primer-600
- Insulation adhesive
- S-Vap 5000 E SA
- Substrate\*

\*Prime as required



# THE RIGHT ROOFING SOLUTION, FOR EVERY PROJECT

## REFURBISHMENT



### Sikalastic® D-20 RoofPro One

**High Performance, Single Component, Solvent-free and low VOC Roof Waterproofing Membrane**

Sikalastic® D-20 RoofPro One is a single component, cold-applied, solvent-free and low VOC roof waterproofing membrane, based on silane terminated polymers. It cures to form a seamless and durable waterproofing solution for exposed roof areas and structures, in both new build and refurbishment projects. Solvent-free and low VOC means that this wet-on-wet application membrane can be applied in scenarios that are sensitive to chemical handling and odour concerns.

**Used for:** roof waterproofing solutions that have complex detail areas, even when accessibility is limited; for the cost-efficient life cycle extension of failing roofs; and application scenarios that are sensitive to chemical handling and odour concerns

- Single component, cold-applied seamless membrane
- Solvent-free and low VOC – non-toxic and VOC compliant
- Reinforced with polyester fleece to give a tough and durable membrane
- Elastic- retains flexibility even at low temperatures
- Wet-on-wet application – for fast installation



### Sikalastic® D-10 RoofPro

**Single Component, Liquid Applied Polyurethane Waterproofing Membrane**

Sikalastic® D-10 RoofPro is a moisture-triggered polyurethane membrane that cures to form a seamless, durable, weather-resistant, and waterproofing solution, for both refurbishment and new build work.

**Used for:** roof waterproofing solutions in both refurbishment and new build work, for roofs displaying complex detail areas, even when accessibility is limited. In addition, it can be used for the cost-efficient life cycle extension of failing roofs.

- Single component - no mixing, easy, and ready to use
- Cold-applied - requires no heat or flame
- Seamless membrane - compatible with Sika® Reemat Premium, which is easy to detail
- Easily re-coated when needed - no stripping required
- Waterproof and vapour permeable
- Elastic - retains flexibility even at low temperatures
- Fast curing - free from rain damage almost immediately on application



### Sikalastic® D-15 RoofPro Advanced

**Single Component, High Performance Waterproof Coating System**

Sikalastic® D-15 RoofPro Advanced is a moisture-triggered polyurethane membrane that cures to form a seamless, durable, weather-resistant, and waterproofing solution, for both new build and refurbishment projects.

**Used for:** waterproofing of flat and pitched roof structures, communal walkways, podium decks, and terraced roofs. It is applicable to existing concrete, roofing felt, brickwork, and asbestos cement decks (subject to condition and priming requirements).

- Cold-applied with a quick and easy application, by spray, brush, or roller
- Seamless membrane, based on moisture-triggered chemistry
- Waterproof and vapour permeable
- Elastic - retains flexibility at low temperatures, and is tolerant of thermal movement
- Can be applied all year round, above +2°C

# SIKA FULL RANGE SOLUTIONS FOR CONSTRUCTION:



LIQUID APPLIED  
ROOFING



SINGLE PLY ROOFING

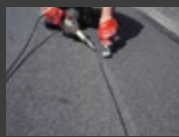

BITUMINOUS ROOFING



CONCRETE



CONCRETE REPAIR



STRUCTURAL  
STRENGTHENING

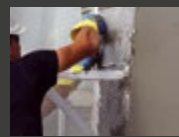

BUILDING FINISHING



WATERPROOFING



JOINT SEALING



FACADES



FLOORING



INDUSTRY



DISTRIBUTION



BUILDING TRUST

## FOR MORE INFORMATION:

### CONTACT

#### Craig Freeman

Business Development Manager (North), Roofing Distribution

E-Mail: [freeman.craig@uk.sika.com](mailto:freeman.craig@uk.sika.com)

Phone: 07860 594370

#### James Buckley

Business Development Manager (South), Roofing Distribution

E-Mail: [buckley.james@uk.sika.com](mailto:buckley.james@uk.sika.com)

Phone: 07818 334584

### WHO WE ARE

Sika Limited and Sika Ireland Limited are part of the global Sika Group, specialising in the manufacture and supply of chemical based products. Sika has a leading position in the development and production of systems and products for bonding, sealing, damping, reinforcing, and protecting in the building sector and the motor vehicle industry. Sika has subsidiaries in 100 countries around the world and manufactures in over 300 factories. With more than 25,000 employees Sika generates annual sales of CHF 7.9 billion (£6.14 bn). We are also committed to providing quality, service, safety and environmental care.

In the UK and Ireland, we provide market-leading solutions for concrete, waterproofing, roofing, flooring, refurbishment, sealing & bonding, and industry, and have manufacturing sites in Welwyn Garden City, Preston, Leeds, Wishaw and Dublin with more than 920 employees and a turnover of more than £290 million.

The information, and, in particular, the recommendations relating to the application and end use of Sika® products, are given in good faith based on Sika's current knowledge and experience of the products when properly stored, handled and applied under normal conditions. In practice, the differences in materials, substrates and actual site conditions are such that no warranty in respect of merchantability or of fitness for a particular purpose, nor any liability arising out of any legal relationship whatsoever, can be inferred either from this information, or from any written recommendations, or from any other advice offered. The proprietary rights of third parties must be observed. Please refer to our homepage [www.sika.co.uk](http://www.sika.co.uk) for our current standard terms & conditions applicable to all orders. Users should always refer to the most recent issue of the Product Data Sheet for the product concerned, copies of which will be supplied on request.



#### SIKA LIMITED

Head Office

Watchmead

Welwyn Garden City

Hertfordshire, AL7 1BQ

United Kingdom

#### Contact

Phone +44 1 707 394444

Fax +44 1 707 329129

E-Mail [enquiries@uk.sika.com](mailto:enquiries@uk.sika.com)

[www.sika.co.uk](http://www.sika.co.uk)

@SikaLimited

